

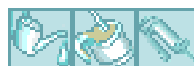

Linear ball bearings KH

with preservative, not sealed, with relubrication facility

The datasheet is only an overview of dimensions and basic load ratings for the selected series. Please ensure that you note all the guidance in these overview pages. Further information is given on many products under the menu item "Description". You can also obtain comprehensive information material via Catalogue selection (<http://www.ina.de/content.ina.de/en/services/mediathek/library/library.jsp>), by e-mail (kataloge@de.ina.com) or telephone +49 (91 32) 82 - 28 97.

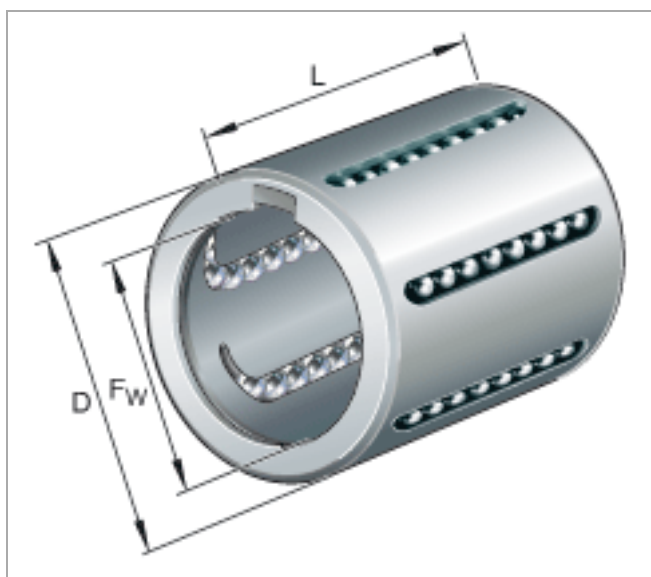

	F _w mm	D mm	L mm
KH06	6	12	22
KH08	8	15	24
KH10	10	17	26
KH12	12	19	28
KH14	14	21	28
KH16	16	24	30
KH20	20	28	30
KH25	25	35	40
KH30	30	40	50
KH40	40	52	60
KH50	50	62	70
	F _w mm	D mm	L mm



Figure 1

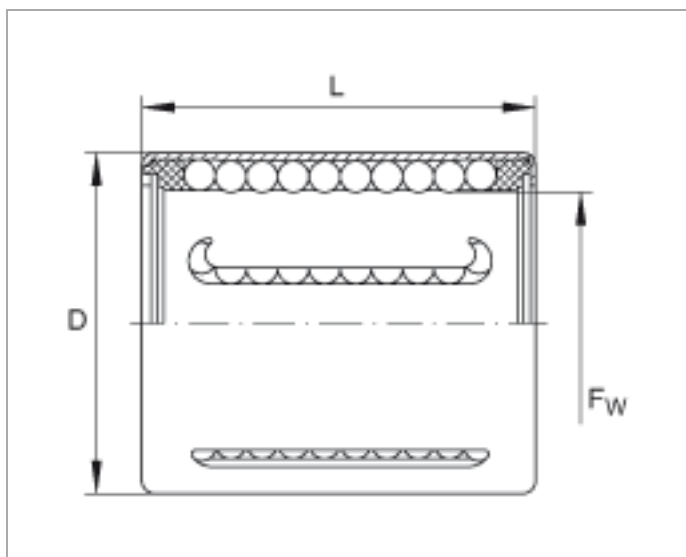
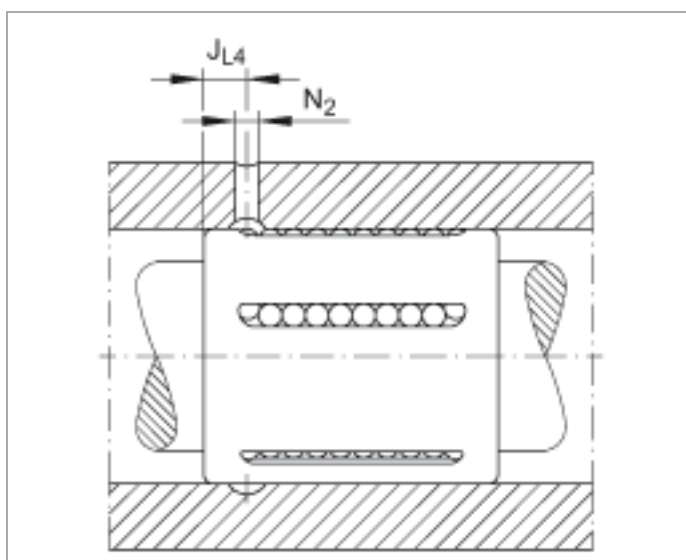

Figure 2



KH06

Figure 1 , Figure 2

Fw	6 mm	
D	12 mm	
L	22 mm	
		Shaft diameter dLw, Fase x dLw ≤ 10: x = 1 tolerance +1 10 < dLw ≤ 30: x = 1,5 tolerance +1 30 < dLw ≤ 80: x = 2,5 tolerance +1
JL4	4 mm	
N2	2 mm	
		Supplied coated with a preservative
m	7 g	Mass of bearing
		The basic load ratings are only valid for hardened (670+170 HV) and ground shaft raceways.
Cmin	340 N	Basic dynamic load rating
C0 min	240 N	Basic static load rating
Cmax	390 N	Basic dynamic load rating
C0 max	340 N	Basic static load rating
		Designs with anti-corrosion protection have the suffix -RR.

KH08

Figure 1 , Figure 2

F _w	8 mm	
D	15 mm	
L	24 mm	
		Shaft diameter d _{Lw} , Fase x d _{Lw} ≤ 10: x = 1 tolerance +1 10 < d _{Lw} ≤ 30: x = 1,5 tolerance +1 30 < d _{Lw} ≤ 80: x = 2,5 tolerance +1
JL4	6 mm	
N2	2 mm	
		Supplied coated with a preservative
m	12 g	Mass of bearing
		The basic load ratings are only valid for hardened (670+170 HV) and ground shaft raceways.
C _{min}	410 N	Basic dynamic load rating
C _{0 min}	280 N	Basic static load rating
C _{max}	475 N	Basic dynamic load rating
C _{0 max}	400 N	Basic static load rating
		Designs with anti-corrosion protection have the suffix -RR.

KH10

Figure 1 , Figure 2

Fw	10 mm	
D	17 mm	
L	26 mm	
		Shaft diameter dLw, Fase x dLw ≤ 10: x = 1 tolerance +1 10 < dLw ≤ 30: x = 1,5 tolerance +1 30 < dLw ≤ 80: x = 2,5 tolerance +1
JL4	6 mm	
N2	2,5 mm	
		Supplied coated with a preservative
m	14,5 g	Mass of bearing
		The basic load ratings are only valid for hardened (670+170 HV) and ground shaft raceways.
Cmin	510 N	Basic dynamic load rating
C0 min	370 N	Basic static load rating
Cmax	590 N	Basic dynamic load rating
C0 max	520 N	Basic static load rating
		Designs with anti-corrosion protection have the suffix -RR.

KH12

Figure 1 , Figure 2

F _w	12 mm	
D	19 mm	
L	28 mm	
		Shaft diameter d _{Lw} , Fase x d _{Lw} ≤ 10: x = 1 tolerance +1 10 < d _{Lw} ≤ 30: x = 1,5 tolerance +1 30 < d _{Lw} ≤ 80: x = 2,5 tolerance +1
JL4	6 mm	
N2	2,5 mm	
		Supplied coated with a preservative
m	18,5 g	Mass of bearing
		The basic load ratings are only valid for hardened (670+170 HV) and ground shaft raceways.
C _{min}	670 N	Basic dynamic load rating
C _{0 min}	510 N	Basic static load rating
C _{max}	800 N	Basic dynamic load rating
C _{0 max}	740 N	Basic static load rating
		Designs with anti-corrosion protection have the suffix -RR.

KH14

Figure 1 , Figure 2

Fw	14 mm	
D	21 mm	
L	28 mm	
		Shaft diameter dLw, Fase x dLw ≤ 10: x = 1 tolerance +1 10 < dLw ≤ 30: x = 1,5 tolerance +1 30 < dLw ≤ 80: x = 2,5 tolerance +1
JL4	6 mm	
N2	2,5 mm	
		Supplied coated with a preservative
m	20,5 g	Mass of bearing
		The basic load ratings are only valid for hardened (670+170 HV) and ground shaft raceways.
Cmin	690 N	Basic dynamic load rating
C0 min	520 N	Basic static load rating
Cmax	830 N	Basic dynamic load rating
C0 max	760 N	Basic static load rating
		Designs with anti-corrosion protection have the suffix -RR.

KH16

Figure 1 , Figure 2

Fw	16 mm	
D	24 mm	
L	30 mm	
		Shaft diameter dLw, Fase x dLw ≤ 10: x = 1 tolerance +1 10 < dLw ≤ 30: x = 1,5 tolerance +1 30 < dLw ≤ 80: x = 2,5 tolerance +1
JL4	7 mm	
N2	2,5 mm	
		Supplied coated with a preservative
m	27,5 g	Mass of bearing
		The basic load ratings are only valid for hardened (670+170 HV) and ground shaft raceways.
Cmin	890 N	Basic dynamic load rating
C0 min	620 N	Basic static load rating
Cmax	1060 N	Basic dynamic load rating
C0 max	910 N	Basic static load rating
		Designs with anti-corrosion protection have the suffix -RR.

KH20

Figure 1 , Figure 2

Fw	20 mm	
D	28 mm	
L	30 mm	
		Shaft diameter dLw, Fase x dLw ≤ 10: x = 1 tolerance +1 10 < dLw ≤ 30: x = 1,5 tolerance +1 30 < dLw ≤ 80: x = 2,5 tolerance +1
JL4	7 mm	
N2	2,5 mm	
		Supplied coated with a preservative
m	32,5 g	Mass of bearing
		The basic load ratings are only valid for hardened (670+170 HV) and ground shaft raceways.
Cmin	1110 N	Basic dynamic load rating
C0 min	790 N	Basic static load rating
Cmax	1170 N	Basic dynamic load rating
C0 max	1010 N	Basic static load rating
		Designs with anti-corrosion protection have the suffix -RR.

KH25

Figure 1 , Figure 2

Fw	25 mm	
D	35 mm	
L	40 mm	
		Shaft diameter dLw, Fase x dLw ≤ 10: x = 1 tolerance +1 10 < dLw ≤ 30: x = 1,5 tolerance +1 30 < dLw ≤ 80: x = 2,5 tolerance +1
JL4	8 mm	
N2	2,5 mm	
		Supplied coated with a preservative
m	66 g	Mass of bearing
		The basic load ratings are only valid for hardened (670+170 HV) and ground shaft raceways.
Cmin	2280 N	Basic dynamic load rating
C0 min	1670 N	Basic static load rating
Cmax	2420 N	Basic dynamic load rating
C0 max	2130 N	Basic static load rating
		Designs with anti-corrosion protection have the suffix -RR.

KH30

Figure 1 , Figure 2

Fw	30 mm	
D	40 mm	
L	50 mm	
		Shaft diameter dLw, Fase x dLw ≤ 10: x = 1 tolerance +1 10 < dLw ≤ 30: x = 1,5 tolerance +1 30 < dLw ≤ 80: x = 2,5 tolerance +1
JL4	8 mm	
N2	2,5 mm	
		Supplied coated with a preservative
m	95 g	Mass of bearing
		The basic load ratings are only valid for hardened (670+170 HV) and ground shaft raceways.
Cmin	3300 N	Basic dynamic load rating
C0 min	2700 N	Basic static load rating
Cmax	3300 N	Basic dynamic load rating
C0 max	3100 N	Basic static load rating
		Designs with anti-corrosion protection have the suffix -RR.

KH40

Figure 1 , Figure 2

Fw	40 mm	
D	52 mm	
L	60 mm	
		Shaft diameter dLw, Fase x dLw ≤ 10: x = 1 tolerance +1 10 < dLw ≤ 30: x = 1,5 tolerance +1 30 < dLw ≤ 80: x = 2,5 tolerance +1
JL4	9 mm	
N2	2,5 mm	
		Supplied coated with a preservative
m	182 g	Mass of bearing
		The basic load ratings are only valid for hardened (670+170 HV) and ground shaft raceways.
Cmin	5300 N	Basic dynamic load rating
C0 min	4450 N	Basic static load rating
Cmax	5300 N	Basic dynamic load rating
C0 max	4950 N	Basic static load rating
		Designs with anti-corrosion protection have the suffix -RR.

KH50

Figure 1 , Figure 2

Fw	50 mm	
D	62 mm	
L	70 mm	
		Shaft diameter dLw, Fase x dLw ≤ 10: x = 1 tolerance +1 10 < dLw ≤ 30: x = 1,5 tolerance +1 30 < dLw ≤ 80: x = 2,5 tolerance +1
JL4	9 mm	
N2	2,5 mm	
		Supplied coated with a preservative
m	252 g	Mass of bearing
		The basic load ratings are only valid for hardened (670+170 HV) and ground shaft raceways.
Cmin	6800 N	Basic dynamic load rating
C0 min	6300 N	Basic static load rating
Cmax	6800 N	Basic dynamic load rating
C0 max	7000 N	Basic static load rating
		Designs with anti-corrosion protection have the suffix -RR.